



Cat[®] 301.4C

MINI HYDRAULIC EXCAVATOR

Specifications

Engine

Engine Model	Yanmar 3TNV76	
Rated Net Power (ISO 9249)	13.2 kW	17.7 hp
Gross Power	17.9 kW	24.3 hp
Displacement	1116 cm ³	68.1 in ³

Weight

Operating Weight with Cab	1470 kg	3,241 lb
Operating Weight with Canopy	1380 kg	3,042 lb
Operating Weight with Cab and Extending Undercarriage	1558 kg	3,435 lb
Operating Weight with Canopy and Extending Undercarriage	1468 kg	3,236 lb

Note: Weights do not include worktools.

Travel System

Travel Speed	2.5 km/h	1.55 mph
Gradeability	30°/58%	
Track Width	230 mm	9.06 in

Service Refill Capacities

Fuel Tank Capacity	24 L	6.3 gal
Hydraulic Tank Capacity	20 L	5.3 gal

Hydraulic System

Pump Flow at 2,200 rpm	35 L/min	9.2 gal/min
Operating Pressure – Equipment	200 bar	2,901 psi
Operating Pressure – Travel	200 bar	2,901 psi
Operating Pressure – Swing	150 bar	2,176 psi
Max. Bucket Force	16 kN	3,597 lbf
Max. Stick Force	7.1 kN	1,596 lbf

Blade

Width	980 mm	38.6 in
Height	232 mm	9.1 in
Dig Depth	264 mm	10.4 in
Lift Height	211 mm	8.3 in

Operating Specifications

Stick Length – Standard	940 mm	37.1 in
Stick Length – Long	1100 mm	43.2 in
Machine Overhang	424 mm	16.7 in

Lift Capacity at Ground Level

Lift Point Radius		2000 mm (78.7 in)				3000 mm (118.1 in)				Maximum			
		Front		Side		Front		Side		Front		Side	
		kg	lb	kg	lb	kg	lb	kg	lb	kg	lb	kg	lb
Undercarriage Width	990 mm (39 in)	715*	1,576*	335	739	385*	849*	200	441	350*	772*	190	419
	1300 mm (51.2 in)	715*	1,576*	495	1,091	385*	849*	300	661	350*	772*	275	606

* The above loads are in compliance with hydraulic excavator lift capacity rating standard ISO 10567:2007 and they do not exceed 87% of hydraulic lifting capacity or 75% of tipping capacity. The excavator bucket weight is not included on this chart.

301.4C Mini Hydraulic Excavator

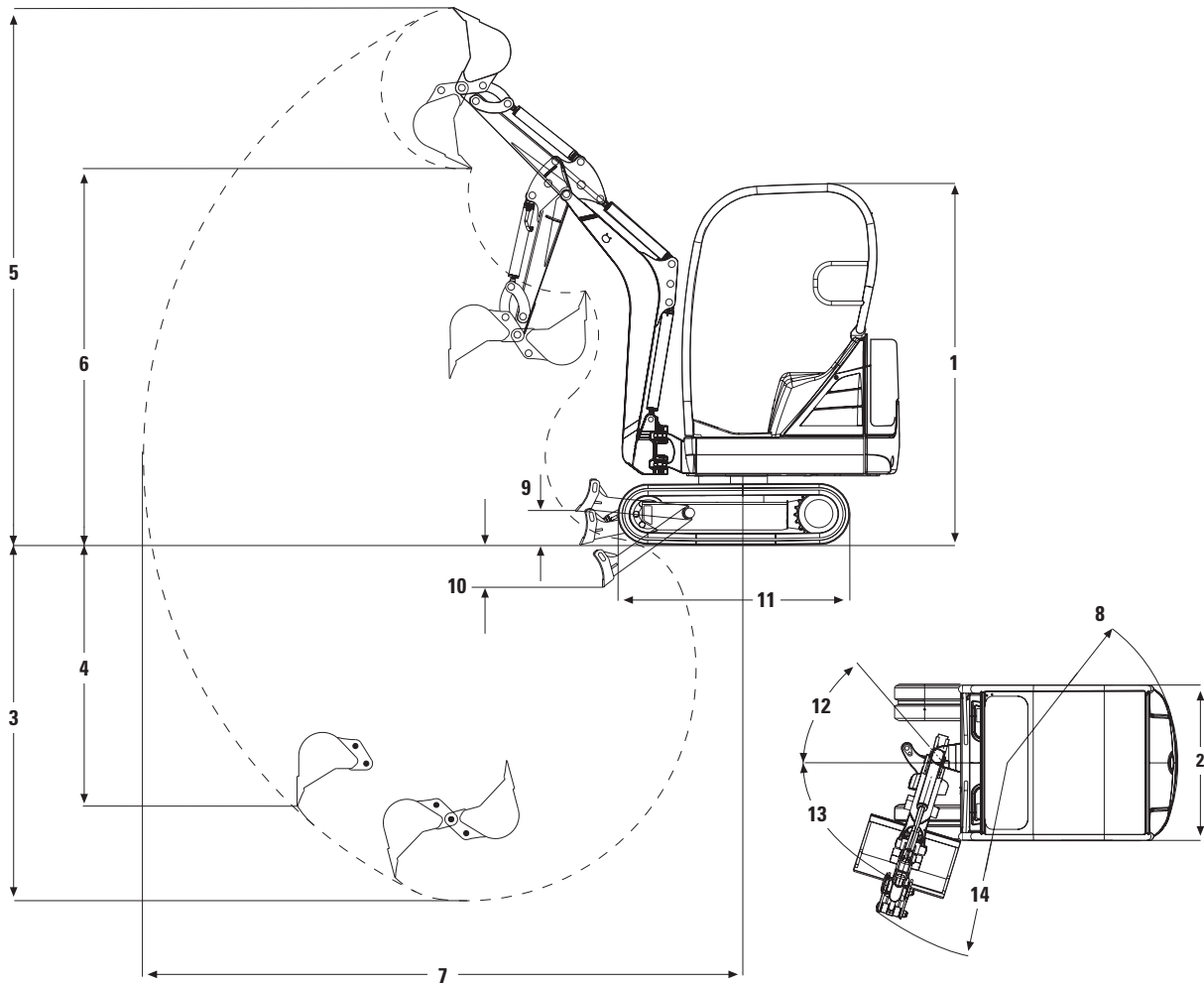

Dimensions (All dimensions are approximate)

	Standard Stick		Long Stick	
1 Height	2276 mm	7 ft 6 in	2276 mm	7 ft 6 in
2 Width	730 mm	2 ft 5 in	730 mm	2 ft 5 in
Undercarriage Width – Retracted	990 mm	3 ft 3 in	990 mm	3 ft 3 in
Undercarriage Width – Extended	1300 mm	4 ft 3 in	1300 mm	4 ft 3 in
3 Maximum Digging Depth	2210 mm	7 ft 2 in	2370 mm	7 ft 7 in
4 Maximum Vertical Digging Depth	1482 mm	4 ft 8 in	1626 mm	5 ft 3 in
5 Maximum Digging Height	3393 mm	11 ft 1 in	3507 mm	11 ft 5 in
6 Maximum Dumping Height	2403 mm	7 ft 9 in	2517 mm	8 ft 3 in
7 Maximum Digging Radius	3700 mm	12 ft 2 in	3850 mm	12 ft 6 in
Maximum Reach on the Ground	3636 mm	11 ft 9 in	3791 mm	12 ft 4 in
8 Tail Swing Radius	1075 mm	3 ft 6 in	1075 mm	3 ft 6 in
9 Maximum Lift of Dozer Blade Above Ground	211 mm	8.3 in	211 mm	8.3 in
10 Maximum Digging Depth of Dozer Blade Below Ground	264 mm	10.4 in	264 mm	10.4 in
11 Track Length	1460 mm	4 ft 9 in	1460 mm	4 ft 9 in
12 Maximum Swing Angle of Boom System to the Right	49°		49°	
13 Maximum Swing Angle of Boom System to the Left	73°		73°	
14 Minimum Boom Swing Radius	1490 mm	4 ft 11 in	1490 mm	4 ft 11 in

301.4C Mini Hydraulic Excavator

STANDARD EQUIPMENT (Standard equipment may vary. Consult your Cat dealer for details.)

- 1-way and 2-way (combined function) auxiliary hydraulic lines
- 230 mm (9.06 in) rubber track
- Boom mounted light
- Canopy with Tip-Over Protection (TOPS) ISO 12117
- Control pattern changer (not available in Europe) Dozer blade
- Dozer blade
- Hydraulic oil cooler
- Maintenance free battery
- Retractable seat belt
- Suspension seat, vinyl covered
- Travel pedals

OPTIONAL EQUIPMENT (Optional equipment may vary. Consult your Cat dealer for details.)

- Bio oil
- Boom check valve
- Cab, radio ready with FOPS ISO 10262 (Level 1), Tip-Over Protection (TOPS) ISO 12117, heater/defroster, interior light and windscreen wiper/washer
- Custom color paint
- Ecology drain for engine oil
- Front screen guard for canopy
- Hydraulic quick coupler lines
- Mechanical quick coupler
- Mirror pack
- Radio ready preparation
- Roof mounted cab worklights
- Rotating beacon
- Suspension seat, fabric covered
- Telescopic undercarriage and blade extensions (900-1300 mm [35.4-51.2 in]) (standard in North America)
- Toolkit
- Travel alarm

301.4C Mini Hydraulic Excavator

For more complete information on Cat products, dealer services, and industry solutions, visit us on the web at www.cat.com

© 2015 Caterpillar
All Rights Reserved
Printed in U.S.A.

Materials and specifications are subject to change without notice. Featured machines in photos may include additional equipment. See your Cat dealer for available options.

CAT, CATERPILLAR, SAFETY.CAT.COM, their respective logos, "Caterpillar Yellow" and the "Power Edge" trade dress, as well as corporate and product identity used herein, are trademarks of Caterpillar and may not be used without permission.

AEHQ6334-03 (02-15)
Replaces AEHQ6334-02

