



Cat[®] 7295

ELECTRIC ROPE SHOVEL

Specifications

Dimensions

Dipper payload	45.4 tonnes	50 tons
Dipper capacity	18.4-39.0 m ³	24-51 yd ³
Length of boom	18.0 m	59 ft 0 in
Effective length of dipper handle	9.45 m	31 ft .25 in
Overall length of dipper handle	12.65 m	41 ft 6 in

Weights

Working weight, with dipper and standard links	789 251 kg	1,740,000 lb
Net weight, domestic, without ballast or dipper	579 691 kg	1,278,000 lb
General purpose dipper 25.2 m ³ (33 yd ³)	49 895 kg	110,000 lb
Ballast (furnished by customer)	159 665 kg	352,000 lb

- These weights will vary slightly depending upon dipper and optional equipment selection.

Main Structures

Crawler Mounting

Overall width 139.7 cm (55 in) treads, standard	8.2 m	26 ft 11 in
Overall width 182.88 cm (72 in) treads	8.63 m	28 ft 4 in
Overall length of mounting	10.26 m	33 ft 8 in
Total effective bearing area (139.7 cm/55 in treads)	20.81 m ²	224 ft ²
	371.6 kPa	53.9 psi
Total effective bearing area (182.88 cm/72 in treads)	27.2 m ²	293 ft ²
	284.1 kPa	41.2 psi
Number and diameter of rollers		
Lower (16)	71 cm	28 in
Lower rear (2)	89 cm	35 in
Upper	Slides	
Take-up tumblers diameter	120.7 cm	47.5 in
Number and pitch of treads (96)	45 cm	17.8 in

Planetary Propel

- Dual-motor independent drive.

Revolving Frame

Welded, impact-resistant steel		
Length	6.92 m	22 ft 8.37 in
Width	3.20 m	10 ft 6 in

Main Structures (cont'd)

Turntable

Cast alloy steel swing rack pitch diameter	4.37 m	14 ft 4 in
Teeth external cut (face)	20.32 cm	8 in
Tapered, forged alloy steel roller rails diameter	3.92 m	12 ft 10 in
Number of tapered rollers	54	
Tapered rollers diameter	18.73 cm	7.38 in

Swing

- Two parallel shaft units mounted to either side of the revolving frame. Each unit is driven by a vertically mounted motor.

Hoist

- Hoist machinery consists of a motor coupled to two gear reductions, which drive the 137 cm (54 in) hoist drum.

Lube System

- Single-line system applies lubricant and grease via the PLC.
- 4 pumps (2 for lubricant and 2 for grease) located in an insulated, double-walled lube room.

Electrical

Drive

- IGBT Acutrol drive system.

Power Requirements

Voltage	3 phase, 50/60 Hz, 7,200V
Average 15-minute demand	538-753 kW
Peak power	2152 kW

- Other voltages available to suit customer requirements.

Distribution System Requirements

Machine on separate system	2000 kVA
Machine on large system	1320 kVA

Main Electrical Systems

System voltage (nominal)	50/60 Hz, 7,200V
Trail cable (furnished by customer)	SHD-3-#4 at 8,000V
Transformer, auxiliary	250 kVA, 7,200V primary 480V secondary
Lighting transformer	1 × 25 kVA, 120/240V secondary

7295 Electric Rope Shovel

Lights

- HPS lights on boom feet, top of A-frame, machinery house, lube room, control room, utility room and flood lights.
- Incandescent lights on ground lights, walkways and operator's cab.

Front End

Boom

Boom	welded, impact-resistant steel	
Boom point sheaves	twin-grooved, flame-hardened	
Boom point sheave diameters	2.08 m	6 ft 10 in
Handle diameter	86.36 cm	34 in
Wall thickness (nominal)	4.45 cm	1.75 in

Front End (cont'd)

Rope Data

	No.	Diameter	Type	Construction
Hoist	2	57.2 mm (2.25 in)	twin dual	6 × 41
Crowd	1	60.3 mm (2.38 in)	single dual	8 × 37
Retract	1	60.3 mm (2.38 in)	single dual	8 × 37
Boom susp.	4	69.9 mm (2.75 in)	equalized	struct. strand
Dipper trip	1	16.0 mm (0.63 in)	single	7 × 25

Crowd

- Rope Crowd with crowd machinery located at the front center of the revolving frame; consisting of a motor, brake, drum and gearing. Plastic-coated crowd and retract ropes are used to move the dipper handle fore and aft.

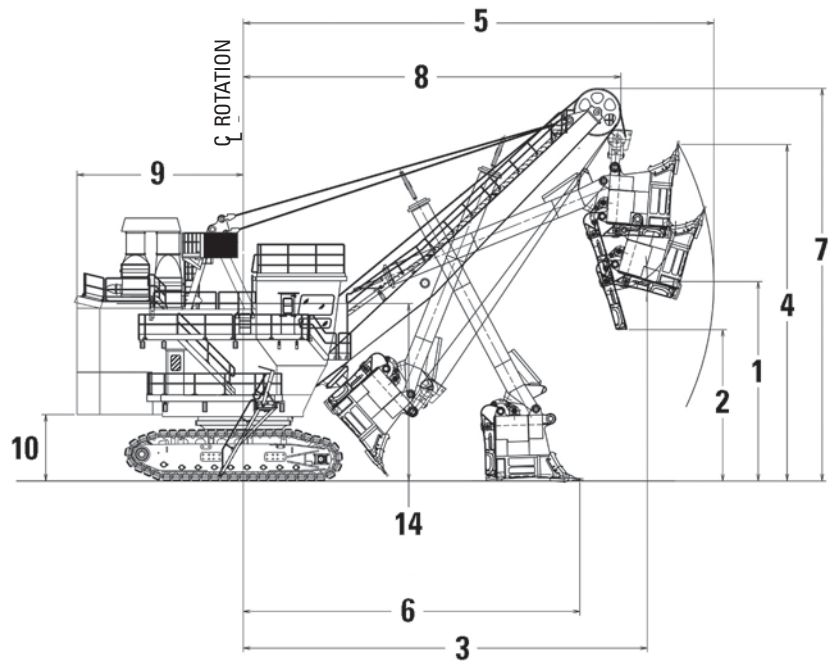
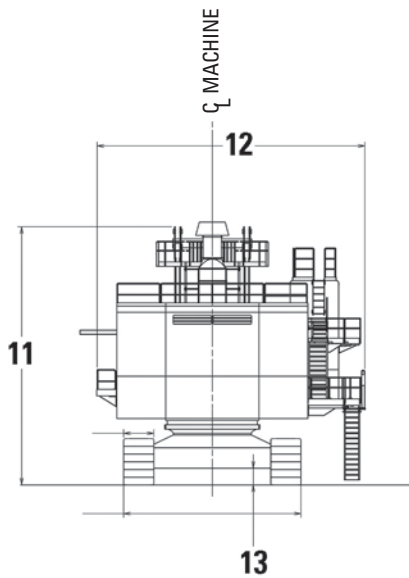

Optimal Working Ranges

1 Dumping height	9.22 m	30 ft 3 in	8 Clearance radius (boom point sheaves)	17.48 m	57 ft 4 in
2 Dumping height at maximum electric crowd limit	7.0 m	23 ft 0 in	9 Clearance radius (revolving frame)	7.98 m	26 ft 2 in
3 Dumping radius (maximum)	18.69 m	61 ft 4 in	10 Clearance under frame (to ground)	3.07 m	10 ft 1 in
4 Cutting height (maximum)	15.56 m	51 ft 1 in	11 Height of A-frame	11.94 m	39 ft 2 in
5 Cutting radius (maximum)	21.78 m	71 ft 5 in	12 Overall width	12.39 m	40 ft 8 in
6 Radius of level floor	15.58 m	51 ft 1 in	13 Clearance under lowest point in truck frame/propel gearcase	0.78 m	30 in
7 Clearance height (boom point sheaves)	18.15 m	59 ft 7 in	14 Operator's eye level	8.20 m	26 ft 11 in

For more complete information on Cat products, dealer services, and industry solutions, visit us on the web at www.cat.com

© 2013 Caterpillar
All Rights Reserved
Printed in U.S.A.

Materials and specifications are subject to change without notice. Featured machines in photos may include additional equipment. See your Cat dealer for available options.

CAT, CATERPILLAR, SAFETY.CAT.COM, their respective logos, "Caterpillar Yellow" and the "Power Edge" trade dress, as well as corporate and product identity used herein, are trademarks of Caterpillar and may not be used without permission.

AEHQ6513-01 (02-13)
Replaces AEHQ6513

